

RIO System



WIRELESS SAFETY
SYSTEM FOR
OPERATORS



CAME

RIO, total wireless safety.

RIO System is the innovative radio-controlled safety system that needs no hard wiring between the control unit and safety accessories. This feature really speeds up installation time. Control unit, photocells, sensitive safety edge and flashing light make up a complete system, based on totally wireless transceiver technology; ideal for bringing any existing systems up to code or for setting up new ones. The control unit is linked to the operator's control panel while the other modules communicate with the unit via radio.

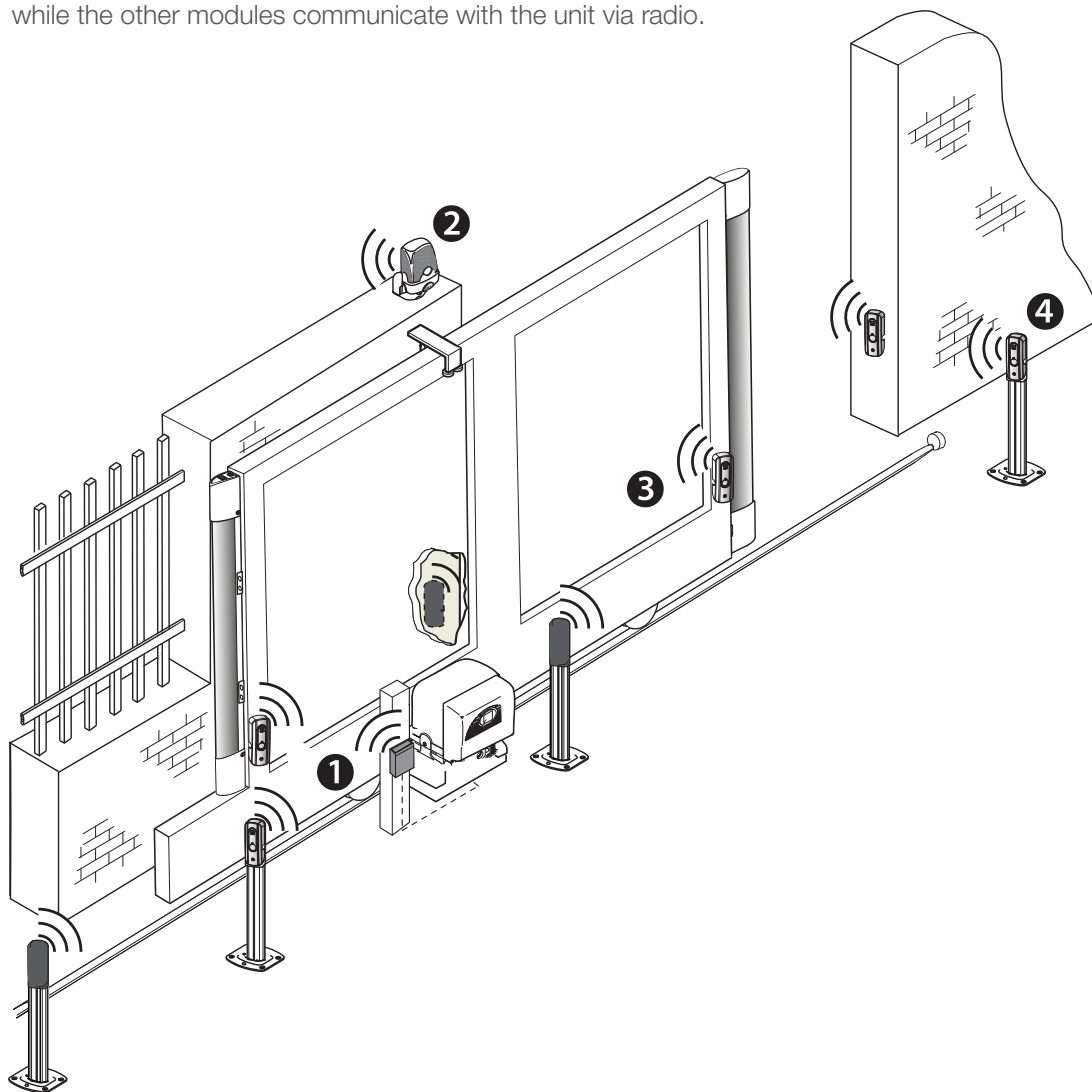

1
RIO CONTROL
wireless command
and control unit



2
RIO LUX
wireless flashing light



3
RIO EDGE
wireless safety edge



4
RIO CELL
wireless photocell

FOR INSTALLERS TOTALLY SIMPLE, QUICK AND ADAPTABLE

- Quicker assembling time compared to standard installations.
- No digging and no masonry work.
- No threading cables.
- Elegant non-invasive design.
- Compatible with any command and control unit.

FOR USERS PRACTICAL, SAFE, ENERGY EFFICIENT

- Total safety compliant with European Standards.
- Immediate solution for bringing your systems up to code, even if they are not set up to do so.
- Low consumption.
- Malfunction and flat battery warnings.

Benefits that turn into solutions.

RIO CONTROL

- Radio controlling device, with a 30 m range, to manage up to 10 RIO series wireless accessories that are programmed during installation.
- LED for monitoring the system and the proper functioning of devices.
- Warning buzzer that activates when the batteries are flat or when any of the wireless accessories malfunction.
- Automatic frequency change in case of any radiofrequency disturbances over the air.
- Special feature to view the radio signal quality and to detect any disturbances.

RIO LUX

- Wireless battery powered flashing light.
- Two high-luminosity warning LEDs for signaling the operator's movement from all angles of view.
- LED for monitoring the system and the proper functioning of devices.

RIO EDGE

- Product certified with category 2 validation which attests to its great safety and reliability.
- Wireless module for controlling one or two resistive sensitive safety edges of the DF-W (8K2), able to transmit and receive from and to RIO CONTROL.
- Battery powered.
- LED for monitoring the system and the proper functioning of devices.
- Warning buzzer which activates when batteries are flat or if radio communication is inefficient.

RIO CELL

- Pair of battery powered wireless photocells, able to transmit and receive to and from RIO CONTROL.
- Infrared signal (range 10 m).
- LED for monitoring the system and the proper functioning of devices.
- Warning buzzer which activates when batteries are flat or if radio communication is inefficient.

Zero-E

Automation's new energy.

Zero-E is the Came solar energy powered system, ideal for road barriers and gates, installed in locations that are not connected to the municipal power grid. **Zero-E** is designed to work with the latest control panels that feature “**SLEEP MODE**” technology, which considerably reduces energy consumption when the motor is idle.



Dadoo

New personality to your home's decor.

Formal elegance and technological innovation merge with a new collection of products meant to enhance each of your home's access points. Low consumption flashing lights with LED technology.

Read more at came.com
about the entire range
of Came products!





MAXIMUM SAFETY OVER TIME

All RIO series devices are compatible among each other to ensure maximum safety in all weather conditions. The issued lithium batteries have a life of two years and a buzzer will tell you when the batteries are flat. Besides the flashing light warns when the batteries are flat with a dedicated flashing mode.



GARANZIA QUALITÀ ORIGINALE

Came products are entirely designed and made in ITALY



Came Cancelli Automatici S.p.A. is Quality and Environmentally
UNI EN ISO 9001
UNI EN ISO 14001

Dimensions (mm)

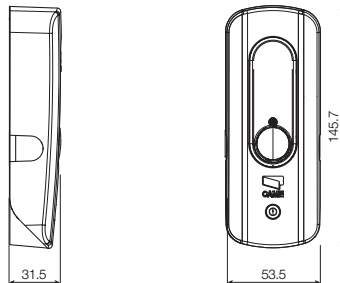
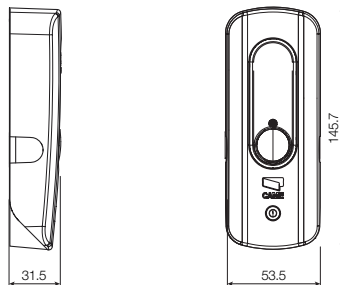
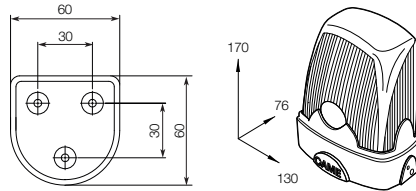
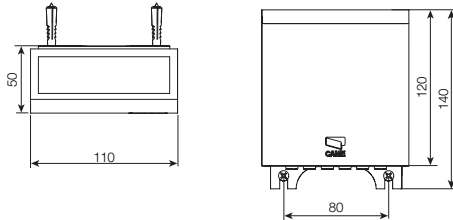

Technical characteristics

MODEL RIO CONTROL

Power supply (V DC)	24
Max current draw (mA)	80
Four relay contacts capacity 24 V (A)	1 Max.
Radio range (m)	30
Number of configurable accessories	10
Frequency (MHz)	868.95

MODEL RIO LUX

Power supply (V DC)	3
Max current draw (μ A)	80
Draw while transmitting (mA)	15
Two lithium CR123A batteries (mAh)	1,700 each
Radio range (m)	30
Frequency (MHz)	868.95
Battery life (months)*	24

* Calculated on an annual average of 20 operations per day

MODEL RIO EDGE

Power supply (V DC)	3
Max current draw (μ A)	80
Draw while transmitting (mA)	15
One lithium CR123A battery (mAh)	1,700
Radio range (m)	30
Frequency (MHz)	868.95
Battery life (months)*	24

* Calculated on an annual average of 20 operations per day

MODEL RIO CELL

Power supply (V DC)	3
Max current draw (μ A)	80
Draw while transmitting (mA)	15
One lithium CR123A battery (mAh)	1,700
Radio range (m)	30
Radio range (m)	10
Frequency (MHz)	868.95
Battery life (months)*	24

* Calculated on an annual average of 20 operations per day

Official Partner



MILANO 2015
FEEDING THE PLANET
ENERGY FOR LIFE

© CAME SPA - KDEP#CENB2A3S114 - JAN 2014 - EN

Even partial reproduction is prohibited • Came reserves the right to make any changes to this document at any time



Came
Cancelli Automatici
S.p.A.

Via Martiri della Libertà, 15
Dossone di Casier
Treviso - Italy

www.came.com

Came is a company of
CAMEGROUP